

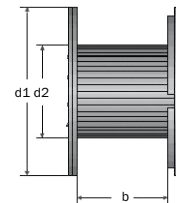

Cable Ø	Length in m per standard supply drum and cable diameter												Cable Ø
	DA 06	DA 07	DA 08	DA 10	DA 12	DA 14	DA 16	DA 18	DA 20	DA 22	DA 24	DA 25	
6	1451	2277	3560										6
7	1054	1617	2622										7
8	811	1288	1993	4213									8
9	618	1020	1515	3244									9
10	523	806	1309	2668									10
11	396	667	1048	2149									11
12	356	560	877	1872									12
13	297	479	768	1615	2287								13
14	243	404	645	1278	1973	2891							14
15	232	336	552	1217	1721	2556							15
16	185	322	466	1039	1487	2195							16
17	175	261	448	901	1304	1950							17
18	143	249	371	772	1132	1817							18
19	135	207	315	726	1069	1595	2488						19
20	127	196	301	632	915	1387	2375	3389					20
21		159	287	590	858	1312	2111	3054					21
22		149	238	506	746	1159	1862	2736					22
23		149	226	487	720	1091	1764	2608	2913				23
24			213	468	618	951	1583	2316	2777				24
25			183	393	595	920	1538	2256	2516				25
26			172	377	572	859	1327	1985	2390				26
27				360	480	736	1286	1781	2148	2488			27
28				295	460	709	1131	1679	2032	2426			28
29				281	440	682	1093	1629	1809	2302			29
30				281	420	597	1056	1446	1756	2053	2477		30
31				267	343	573	916	1400	1548	1996	2408		31
32				253	343	549	882	1230	1500	1762	2144	2507	32
33				211	326	525	848	1188	1451	1711	2081	2435	33
34				199	326	450	754	1145	1403	1659	2018	2167	34
35				199	309	429	724	1145	1219	1607	1777	2101	35
36				187	257	409	694	992	1176	1400	1720	2035	36
37					243	409	664	954	1176	1353	1663	1850	37
38					243	389	581	954	1006	1306	1445	1791	38
39					229	389	554	814	968	1161	1445	1731	39
40					229	307	554	780	968	1120	1393	1671	40
41					214	307	528	780	929	1078	1342	1504	41
42					214	290	528	746	890	1078	1193	1450	42
43					172	290	430	746	779	1037	1147	1397	43
44					160	290	430	623	745	907	1147	1397	44
45					160	273	407	623	745	871	1101	1194	45
46					160	273	407	594	711	835	1055	1194	46
47						256	407	594	711	835	923	1146	47
48						205	385	564	677	798	883	1098	48
49						205	385	564	581	798	883	1098	49
50						205	385	564	581	798	883	1098	50
51						191	302	458	552	653	843	919	51
52						191	302	458	552	653	843	919	52
53						191	302	433	523	622	803	877	53
54						177	283	433	523	622	688	877	54
55						177	283	433	523	622	688	836	55
56						177	283	407	493	591	654	836	56
57							264	407	411	591	654	836	57
58							264	407	411	560	619	680	58
59							264	339	387	467	619	680	59
60							264	318	387	467	619	680	60
61								318	387	467	619	645	61
62								318	387	441	585	645	62

For flat cables: thickness of flat cable is cable diameter
 Cable length: length according to table x cable thickness/cable width

Standard delivery drums



Wooden drums						
New drum designation	Size	Flange diam. d1 mm	Max. winding diam.	Barrel diam. d2 mm	Winding width mm "b"	Weight kg
DA06 without helix	6	600	540	300	330	12
DA07 without helix	7	700	640	350	370	20
DA08 without helix	8	800	740	400	430	33
EA08 with helix	8	800	740	400	405	36
DA10 without helix	10	1,000	940	550	600	65
EA10 with helix	10	1,000	940	550	580	68
DA12 without helix	12	1,200	1,120	700	650	105
EA12 with helix	12	1,200	1,120	700	620	110
DA14 without helix	14	1,400	1,320	850	750	170
EA14 with helix	14	1,400	1,320	850	720	175
DA16 without helix	16	1,600	1,500	900	850	230
EA16 with helix	16	1,600	1,500	900	800	240
DA18 without helix	18	1,800	1,700	1,000	950	320
EA18 with helix	18	1,800	1,700	1,000	900	330
DA20 without helix	20	2,000	1,880	1,250	1,000	400
EA20 with helix	20	2,000	1,880	1,250	920	415
DA22 without helix	22	2,200	2,000	1,300	1,100	450
EA22 with helix	22	2,200	2,000	1,300	1,020	465
DA24 without helix	24	2,400	2,200	1,450	1,100	620
EA24 with helix	24	2,400	2,200	1,450	1,020	635
DA25 without helix	25	2,500	2,300	1,500	1,150	800
EA25 with helix	25	2,500	2,300	1,500	1,070	820

Steel drums						
New drum designation	Size	Flange diam. d1 mm	Max. winding diam.	Barrel diam. d2 mm	Winding width mm "b"	Weight kg
10MC	100(3k)	1,000	940	600	575	56
12MC	120(4k)	1,200	1,120	600	660	82
15MC	150(5k)	1,500	1,400	750	940	150
18MC	180(6k)	1,800	1,700	1,150	895	280
20MC	200(7k)	2,000	1,800	1,200	895	380
22MC	220(8k)	2,200	2,000	1,450	965	475
25MC	250(ZF)	2,500	2,300	1,600	1,250	780